

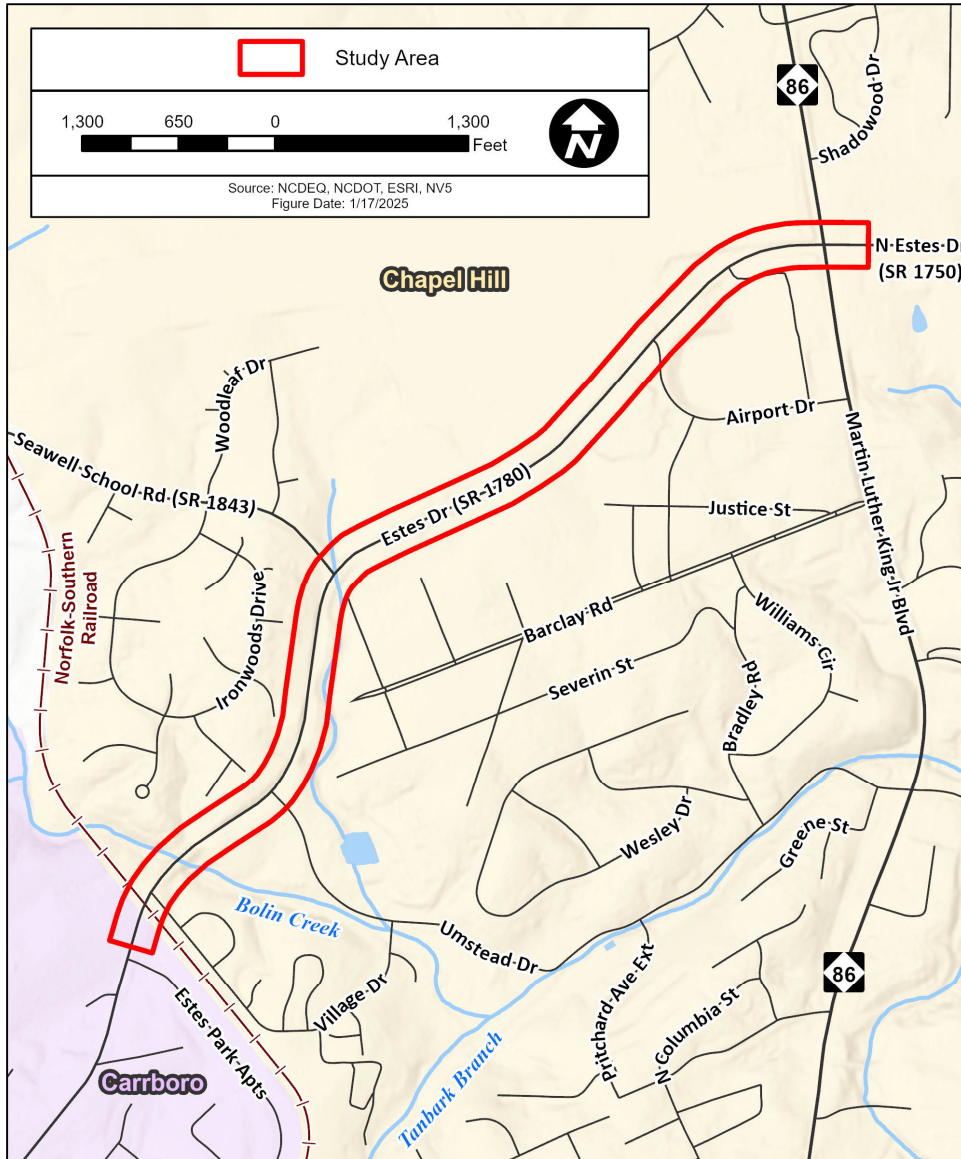

# EB-5886B Estes Drive Extension

Add Bicycle lanes & Pedestrian Paths From Martin Luther King Jr. Boulevard to the Norfolk-Southern Railroad tracks



## PROJECT DESCRIPTION

The Town of Chapel Hill is proposing to add bicycle lanes and pedestrian paths along Estes Drive Extension, from the intersection of Estes Drive and Martin Luther King Jr. Boulevard, to the Chapel Hill limits at the railroad crossing.

This project will connect to the existing bicycle lanes and pedestrian paths now in place on Estes Drive and also to the proposed path for the Bolin Creek Greenway Extension. The project is approximately 1.3 miles in length.

## Estes Drive Project Schedule

### Milestone

Environmental Documentation  
Right of Way Acquisition Begins  
Construction Begins

### Date/ Year

Summer 2025  
Fall 2025  
Fall 2027

# Bike/Ped Options

## Option 1

Two-way Separated Cycle Track and 10-ft Multi-use Path on East/South side of Estes Drive

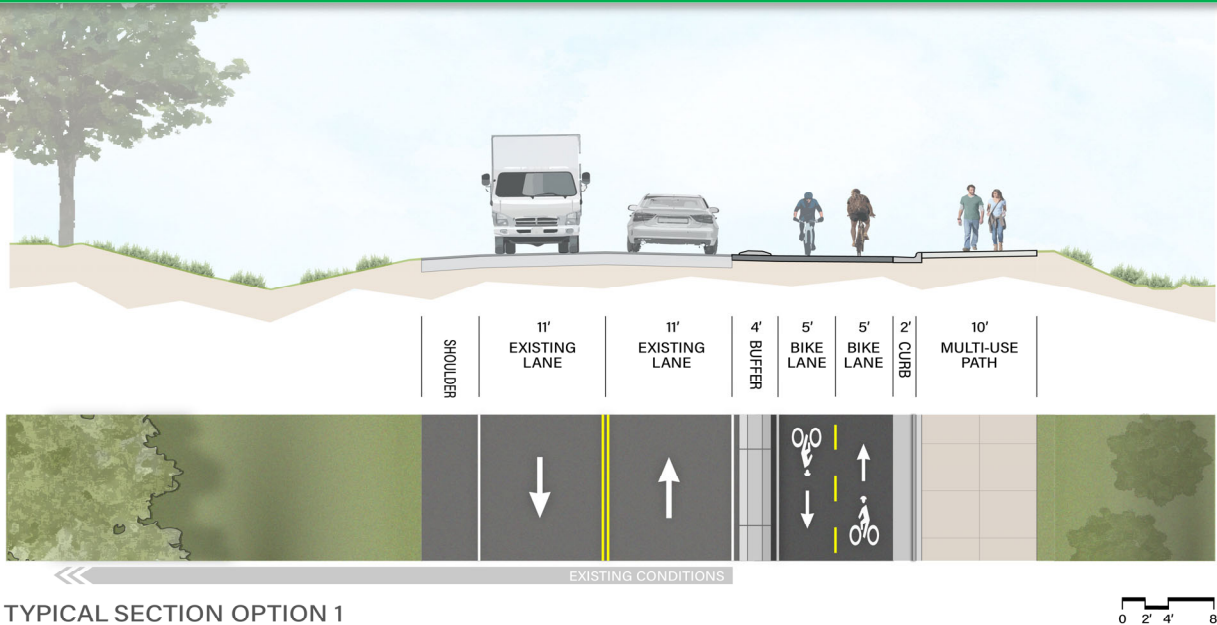

## Option 2

Separated Bike Lanes on both sides of Estes Drive and 10-ft Multi-use Path South side of Estes Drive

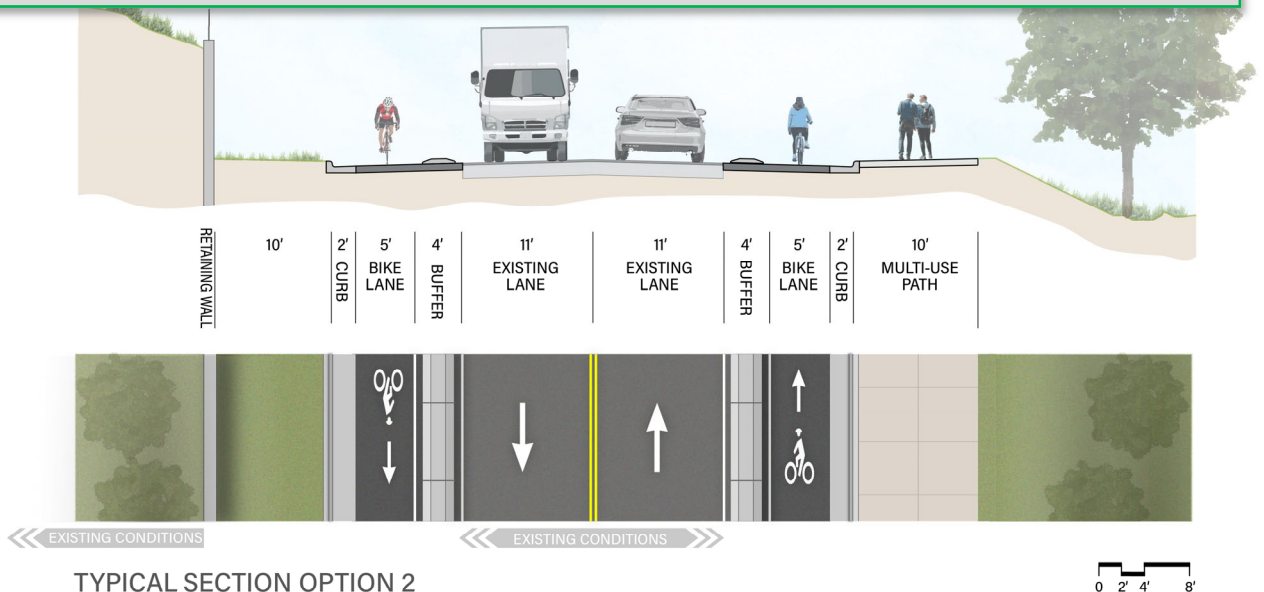

# Bike/Ped Options

## Option 3

11-ft Multi-use Path along both sides of Estes Drive.

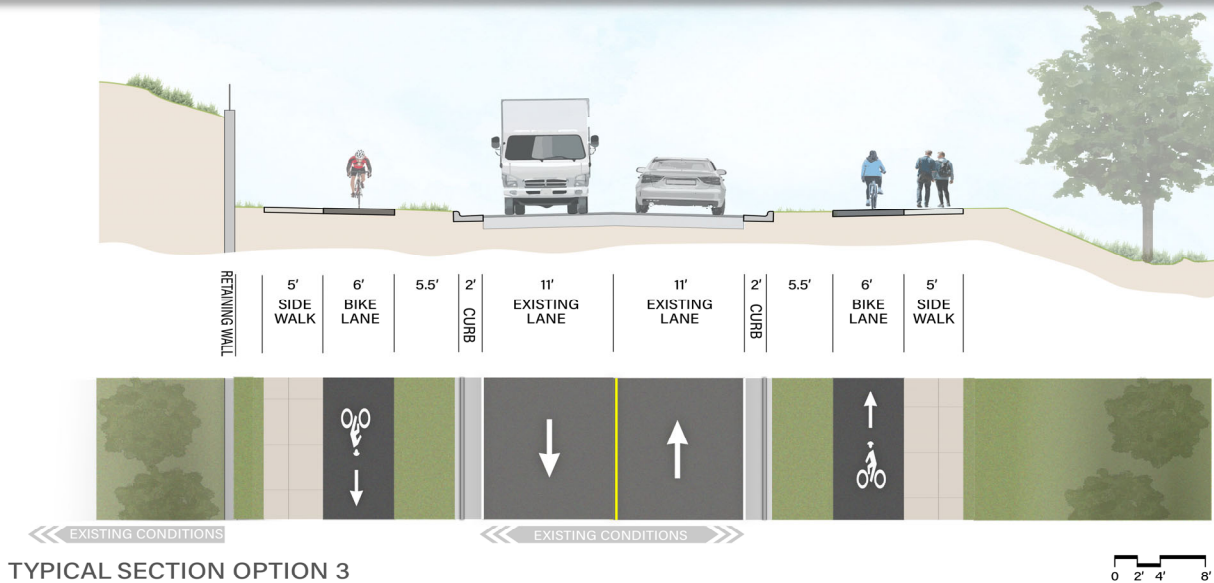

## Option 4

7-ft Bike Lane/Paved Shoulder on West side of Estes Drive with 11-ft Multi-use Path on the East/South side of Estes Drive

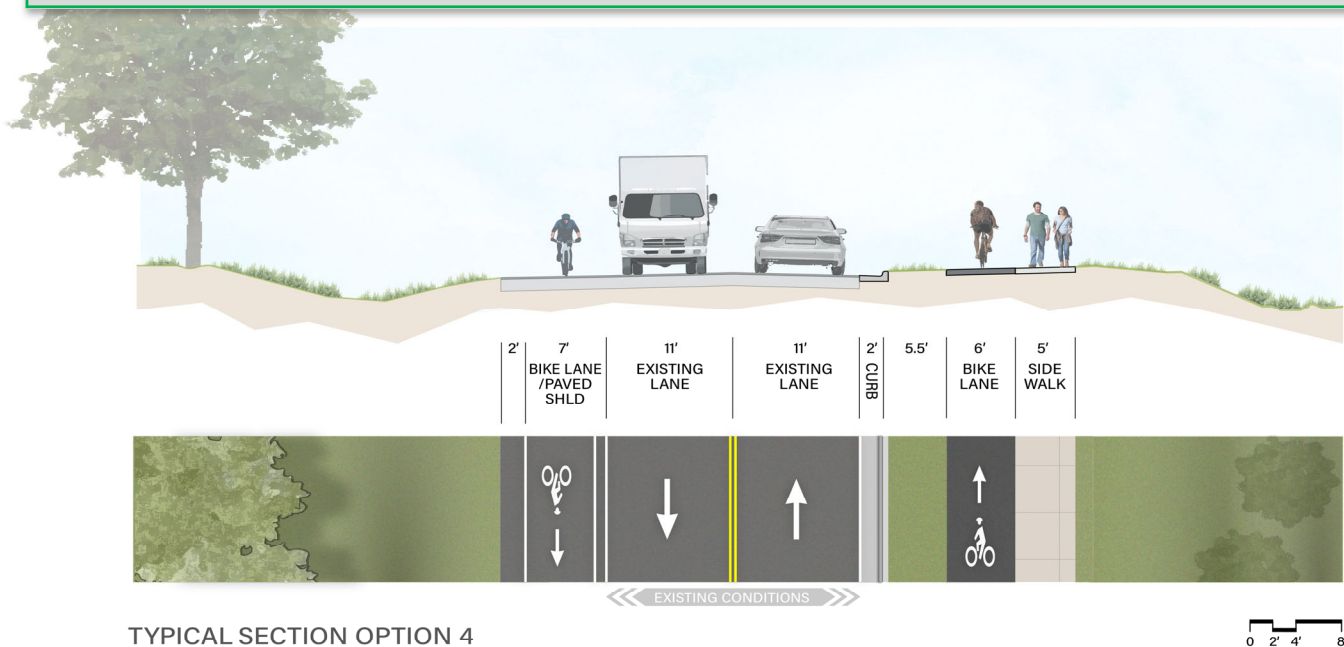

# Bike/Ped Options

## Option 5

Separated Bike Lanes along both sides of Estes Drive and 5-ft sidewalk along East/South side of Estes Drive

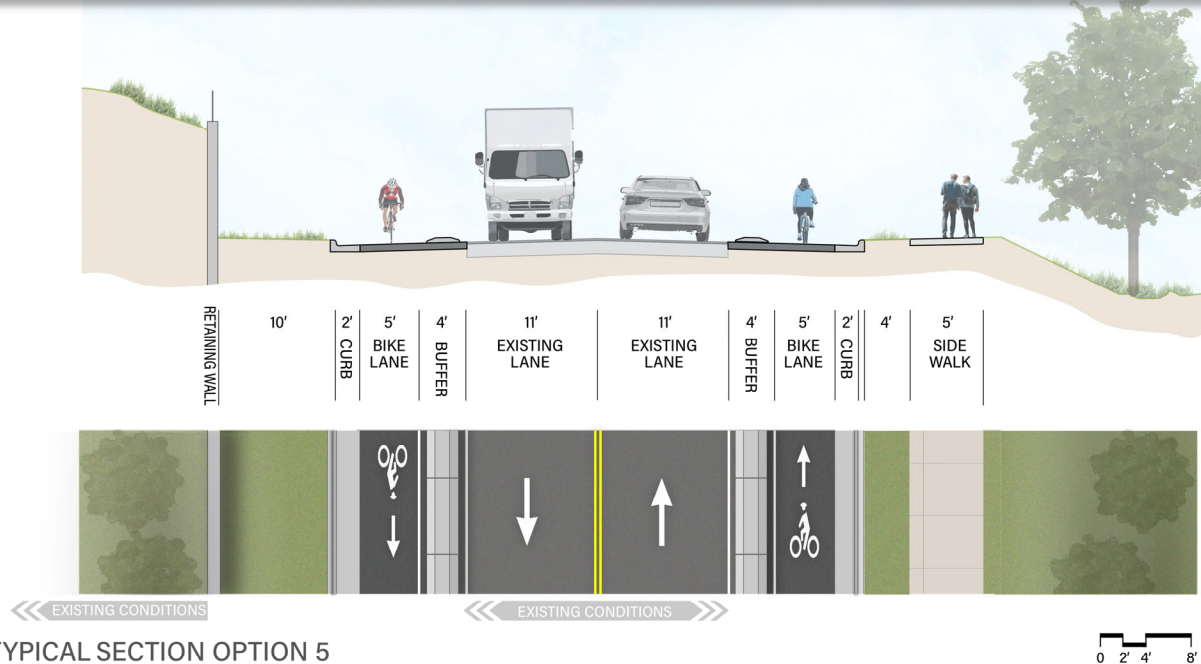

### Access the Project Webpage and View the Public Meeting Maps

<https://engage.chapelhillnc.gov/estes-drive-extension-bicycle-and-pedestrian-improvements>

Comments may be submitted online via the project webpage or at the Public Meeting:



Comments should be submitted by:

**February 7th, 2025**